



<http://designkaboodle.com>

## **Bev's Tutorial**

### **Eye Candy 4 Gradient Glow Fat Preset**

tutorial url : Design Kaboodle.com

<https://designkaboodle.com/blog/psp-help/candy-gradient-preset/>

It has been pointed out to me that some people has the basic preset Fat Preset missing in Eye Candy 4 Gradient Glow ... so if you do not have it this is how to make the preset & save it

### **Making The Preset :**

#### **Go to Eye Candy inside PSP**

#### **1: Go to setting / press reset to factory default**

in the Basic button tab you should have these setting ( click image thumbnails for better view)

Glow Width : 20.16

Soft Corners: 25

Overall OPacity: 100

Draw Only Outside Selection Checked Mark

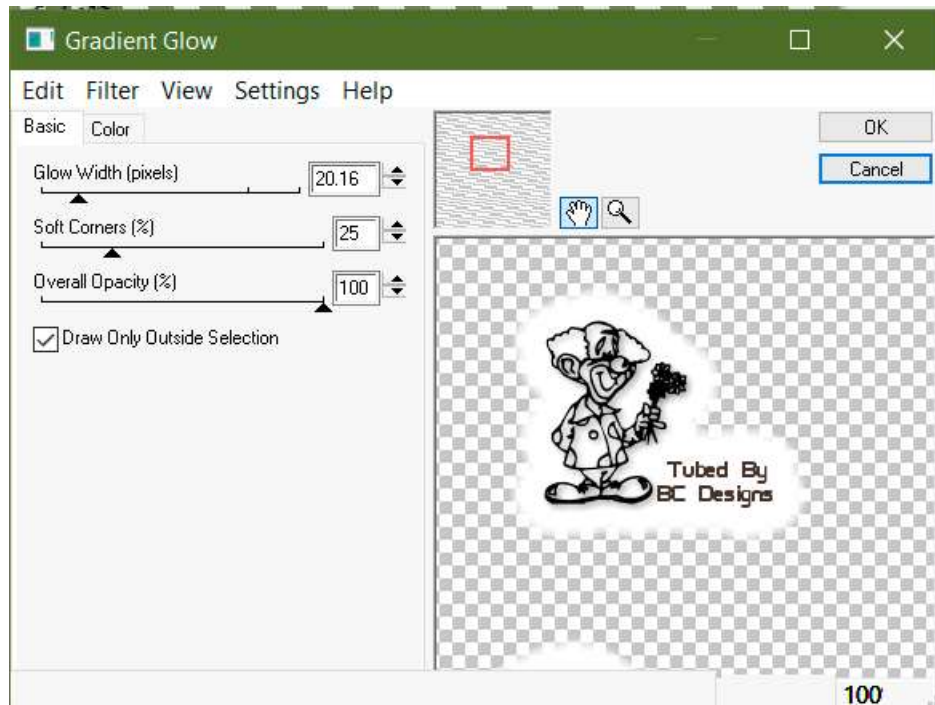

2: Under The Color Tab :

You will see a white box with different preset options pick medium

Pick the color you want ( Default is white you can change this later)

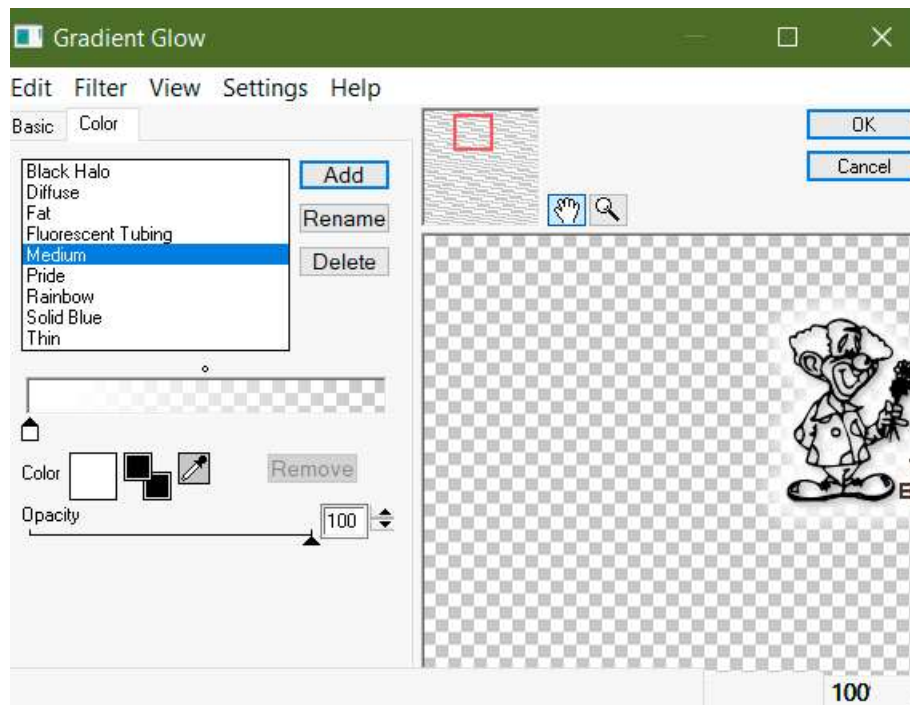

### 3: Still Under the Color Tab

You will see a paint can you might see only one .. ( images above ) if you only have one make another paint can How to : If you click the paint can & move it ... it makes a new one.

Just click the paint can you just made and move it toward the right to match mine below ... You should now only have two cans.

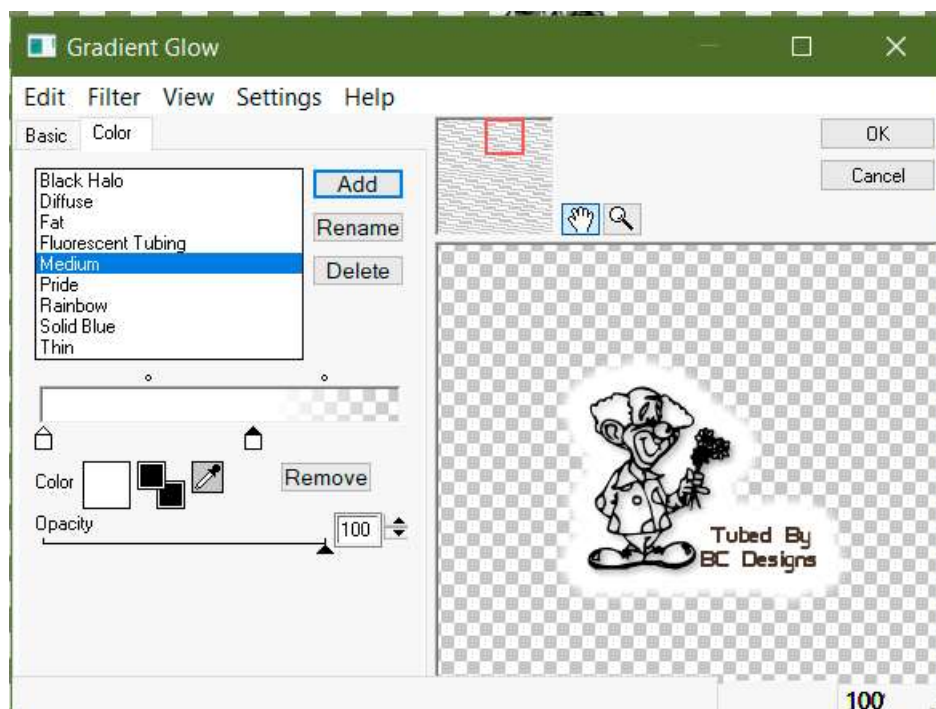
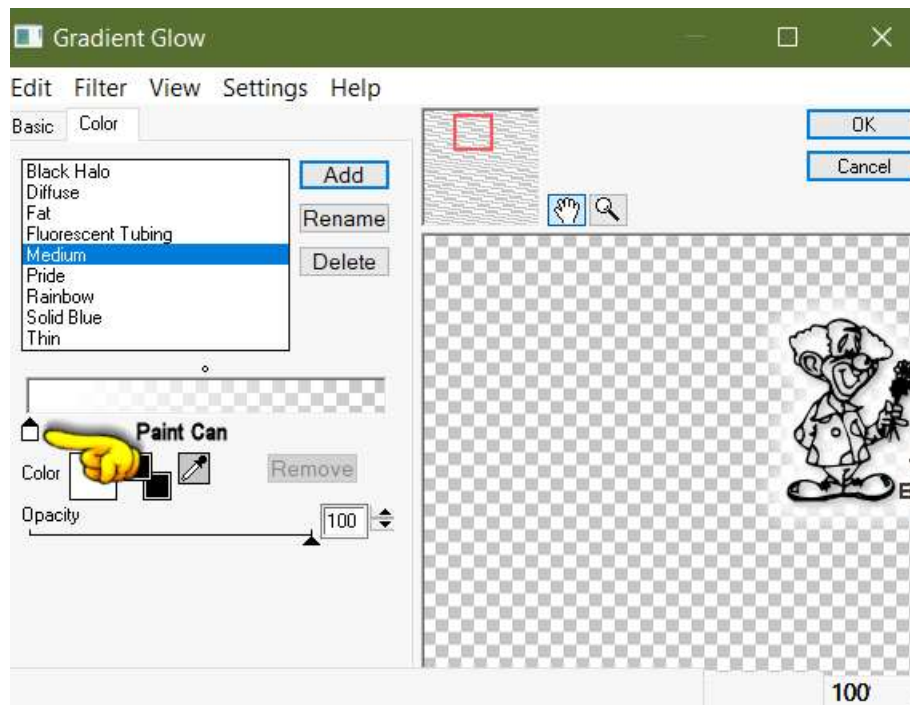

4: if you make a mistake or make to many paint cans just press the paint can you want deleted & press the Remove button below beside Color box

5: Set the Opacity to 100

### **Saving The Preset :**

You are done making the preset lets save it now .. there is two ways to save in Eye Candy Gradient Glow but I am not sure which way you need to Save it so let's save both ways.. to be sure it is saved

6: Go to Settings under the Color Tab and press Save / & call it Fat or what ever you want ...

7: ( I think this is the one you want but not sure )

Under Color Tab you will see three buttons Add, Rename , and Delete ... Press Add and name It you can call it Fat or What ever you want .. you should see it in the list in the white box

It should now show the preset in Eye Candy in PSP. & In your Eye Candy 4 Plugin Folder Alien Skin\Eye Candy 4000\Eye Candy 4000 Settings/Gradients or Gradient Glow Folders,

It should now show the preset in Eye Candy in PSP. & In your Eye Candy 4 Plugin Folder Alien Skin\Eye Candy 4000\Eye Candy 4000 Settings/Gradients or Gradient Glow Folders.

### **and please contact me :**

( Bev ) if you need help here on the blog <http://designkaboodle.com/blog/contact/> or at The Bag A Snag Forums <http://bagasnag.forumotion.com/> .